

TESTED ASSEMBLY

Top of Concrete slab

11 5/8"

2 1/2"

8"

1 1/8"

24"

ComSlab® deck

1/2" Resilient Channel @ 24" O.C. attached to ribs with tapcon fastener.

5/8" Type X Gypsum Board

REPORT NO: 7009076

TESTED ASSEMBLY

The diagram illustrates a cross-section of a tested assembly. It features a concrete slab with a trapezoidal void. The total height of the slab is 12 inches. The void has a depth of 8 inches. The top of the slab is finished with Carpet & Underpad floor finish. The bottom of the slab is finished with a ComSlab® deck. A 7/8" Furring Channel @ 24" O.C. is attached to the ribs with tapcon fasteners. The furring channel is 24 inches wide. The bottom of the furring channel is finished with 5/8" Type X Gypsum Board. The bottom of the slab is finished with 1 1/2 inches of concrete. The top of the slab is finished with 2 1/2 inches of concrete.

Carpet & Underpad floor finish

12"

2 1/2"

8"

1 1/2"

ComSlab® deck

7/8" Furring Channel @ 24" O.C. attached to ribs with tapcon fastener.

24"

5/8" Type X Gypsum Board

REPORT NO: 7009083

TESTED ASSEMBLY

The diagram illustrates a cross-section of a floor assembly with the following layers and dimensions:

- Top Layer:** 5/16" [8mm] Soft Step -Rubber pad
- Insulation:** 3" x 16" Roxul Insulation on top; 3" x 24" Roxul Insulation cut to fit between the ribs.
- Tile Layer:** Tile w/grout and cement
- Quiet Down:** 3/16" [4mm] Quiet down Rubber pad
- Floor Finish:** Top of Floor Finish
- Deck:** ComSlab® deck
- Furring:** 7/8" Furring Channel @ 24" O.C. attached to ribs with tapcon fastener.
- Gypsum Board:** 5/8" Type X Gypsum Board

Dimensions:

- Overall height: 12"
- Top section height: 1"
- Section height: 2 1/2"
- Section height: 8"
- Section height: 1 1/2"
- Channel spacing: 24"

REPORT NO: 7009141

TESTED ASSEMBLY

Carpet & Underpad floor finish

11 ¹/₈"

2 ¹/₂"

8"

1 ¹/₈"

ComSlab® deck

1/2" Resilient Channel @ 24" O.C. attached to ribs with tapcon fastener.

24"

5/8" Type X Gypsum Board

REPORT NO: 7009077

TESTED ASSEMBLY

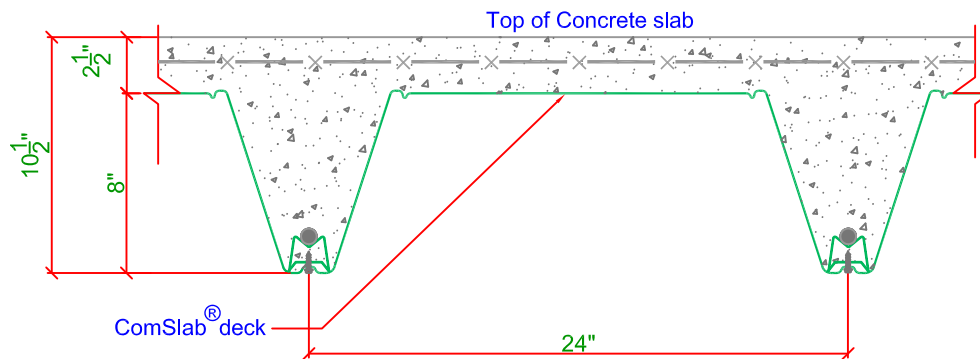

RESULT: STC 47

REPORT NO: 5009077

TESTED ASSEMBLY

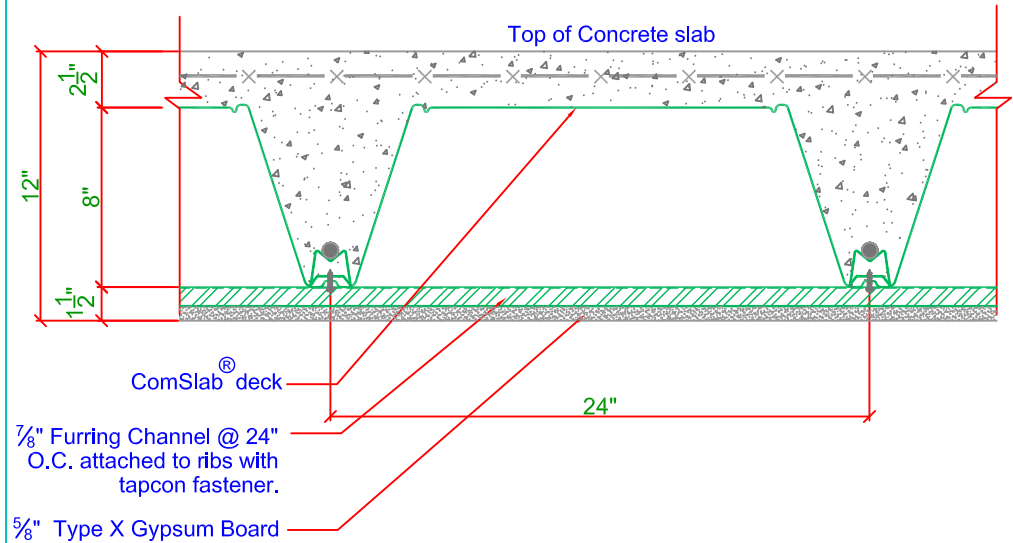

RESULT: STC 56

REPORT NO: 5009050

TESTED ASSEMBLY

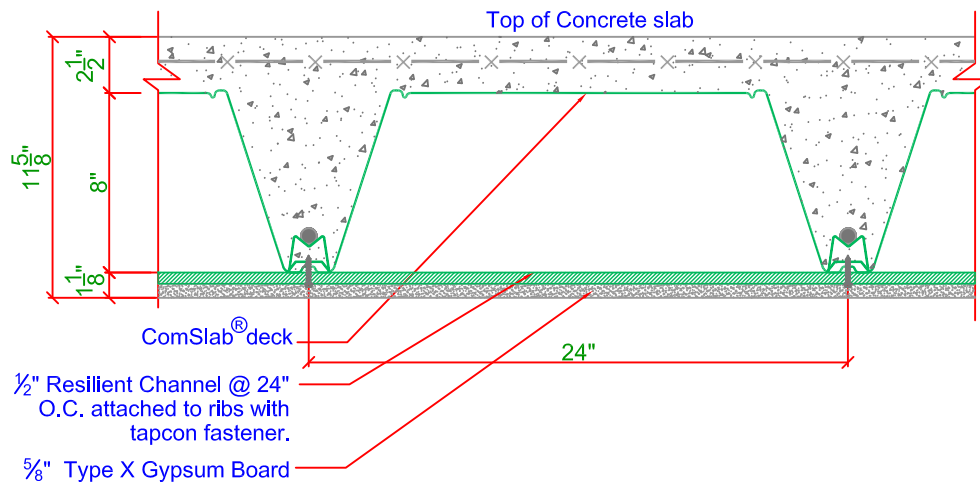

RESULT: STC 58

REPORT NO: 5009047

TESTED ASSEMBLY

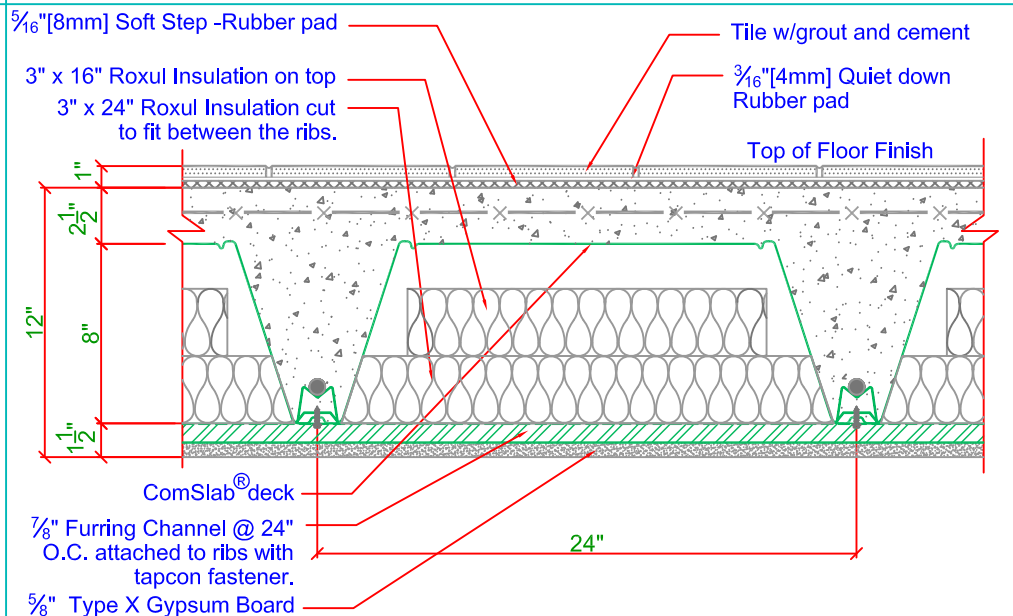

RESULT: STC 60

REPORT NO: 5009076



ONE CALDARI ROAD
CONCORD, ONTARIO
L4K 3Z9

TEL: 905-738-9267
FAX: 905-738-9408
EMAIL: www.bmp-group.com

THIS DRAWING IS PROPERTY OF BAILEY METAL PRODUCTS LTD., AND MAY NOT BE REPRODUCED, COPIED, MODIFIED OR LOANED WITHOUT WRITTEN PERMISSION.

ALL DESIGNS, CONCEPTS OR OTHER INFORMATION SHOWN ON THIS DRAWING ARE FOR USE ON THIS PROJECT ONLY AND SHALL NOT BE USED OTHERWISE WITHOUT WRITTEN PERMISSION.

PROJECT:

TYPICAL DETAILS

TITLE:

ComSlab Acoustical Performance
Tested Assemblies with STC and IIC ratings

PROJECT NO:

DATE: FEB 17, 2012

DRAWN BY: M.A.

CHECK BY: A.A.

SCALE: NOT TO SCALE

DRAWING NO:

1.1