

# LIGHTWEIGHT STEEL FRAMING DETAILS JOISTS FOR FLOORS & ROOFS



MONTREAL • TORONTO • CALGARY • EDMONTON • VANCOUVER

**BAILEY**<sup>®</sup>  
METAL PRODUCTS LIMITED



**BAILEY**<sup>®</sup>  
METAL PRODUCTS LIMITED

Bailey Lightweight Steel Framing (LSF) Joists offer a wide range of span and load capabilities for commercial and residential floor systems and mezzanines. LSF Ceiling Joists and Rafter members can also be utilized for pitched, mansard, and flat roofs. The use of Bailey LSF Joist and Rafter members will provide support for interior drywall ceilings where long clear spans are required.

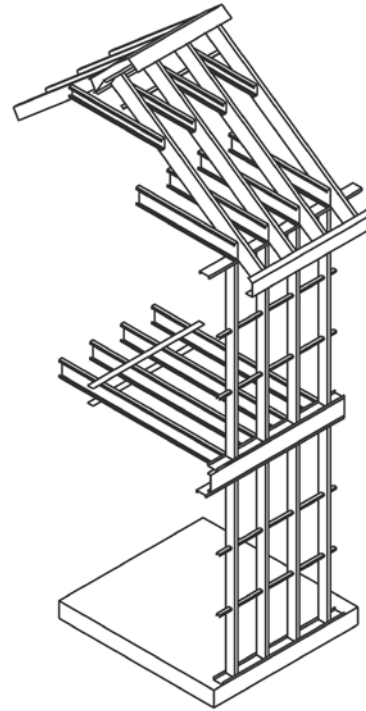

## FLOOR JOISTS

### FLOOR JOIST WITH BRIDGING AND BLOCKING

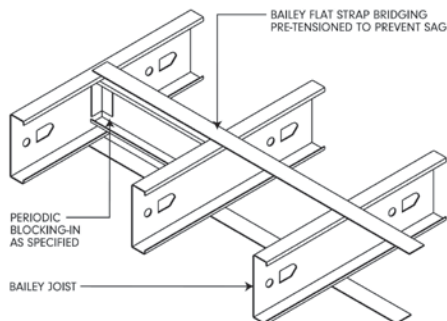

### FLOOR MOUNTED INSIDE CONCRETE WALL

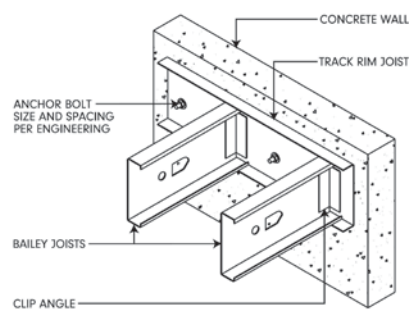

### OPENING IN FLOOR

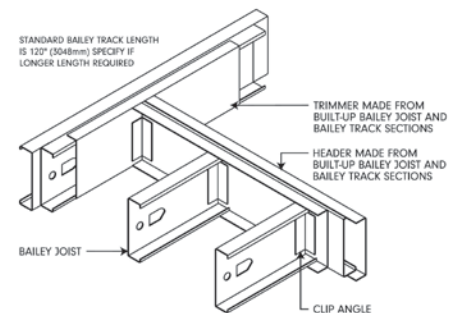

### FLUSH CONNECTION TO SUPPORTING BEAM

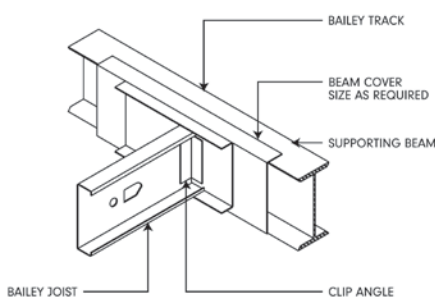

### JOISTS CONTINUOUS OVER SUPPORTING BEAM

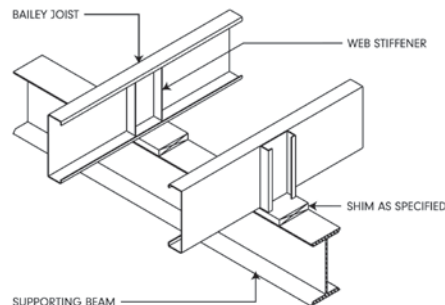

### JOISTS OVERLAPPING SUPPORTING BEAM

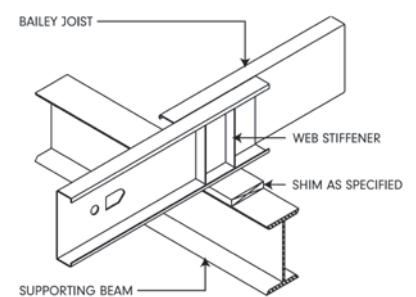

## FLOOR JOISTS

JOIST PERPENDICULAR TO PERIMETER

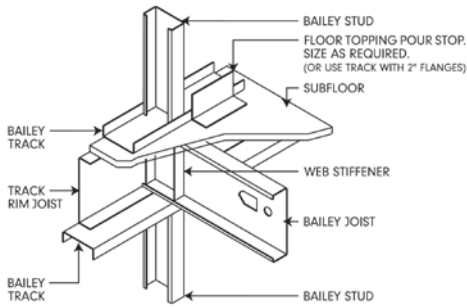

JOIST ABOVE LOADBEARING WALL

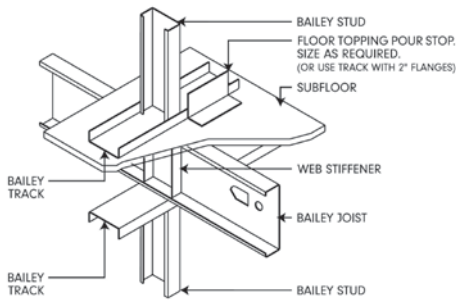

JOIST PARALLEL TO PERIMETER

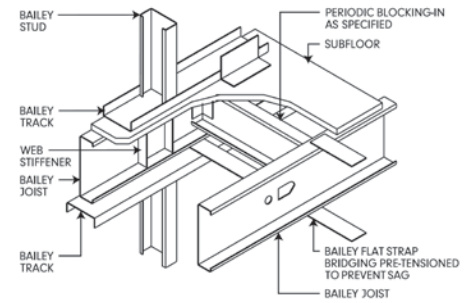

JOIST PERPENDICULAR TO PERIMETER

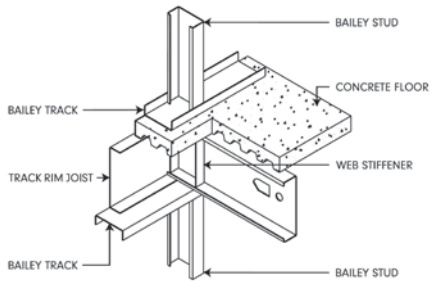

JOIST ABOVE LOADBEARING WALL

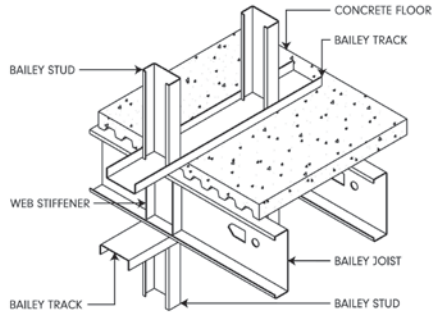

JOIST PARALLEL TO PERIMETER

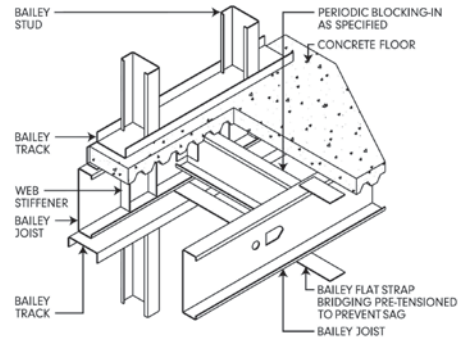

## ROOF JOISTS

RAFTER AT PEAK

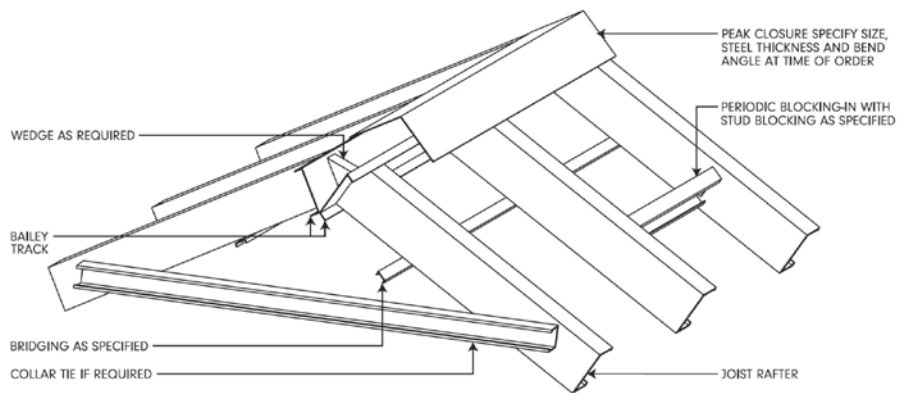

RAFTER AT PERIMETER WALL

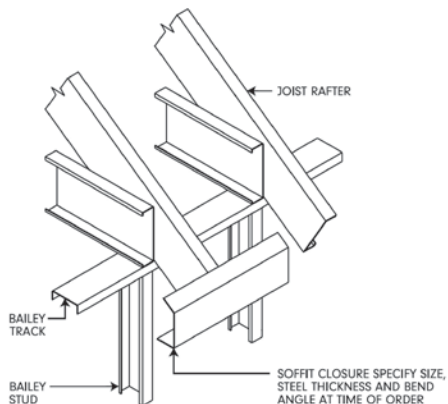

RAFTER AT PERIMETER WALL

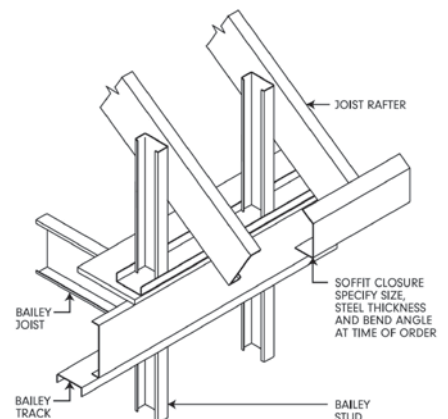

The material presented in this document has been prepared for the general information of the reader. While the material is believed to be technically correct and in accordance with recognized good practice, it should not be used without first securing competent advice with respect to its suitability for any specific application. Bailey Metal Products Limited does not warrant or assume liability for the suitability of the material for any general or particular use.



# BAILEY<sup>®</sup>

METAL PRODUCTS LIMITED

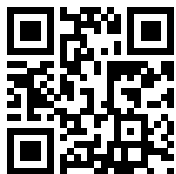

## LIGHTWEIGHT STEEL FRAMING DETAILS JOISTS FOR FLOORS & ROOFS

[sales@bmp-group.com](mailto:sales@bmp-group.com) • [www.bmp-group.com](http://www.bmp-group.com)



JFR07IN16-500

### MONTREAL

525 Avenue Edward VII  
Dorval, QC H9P 1E7  
Tel. (514) 735-3455  
800-263-3455  
Fax. (514) 735-5052

### TORONTO

1 Caldari Road  
Concord, ON L4K 3Z9  
Tel. (905) 738-9267  
800-668-2154  
Fax. (905) 738-5712

### CALGARY

3924 27th Street NE  
Calgary, AB T1Y 5K7  
Tel. (403) 248-3536  
800-665-2013  
Fax. (403) 248-0288

### EDMONTON

5710 Roper Road NW  
Edmonton, AB T6B 3G7  
Tel. (780) 462-5757  
800-563-1751  
Fax. (780) 450-3378

### VANCOUVER

7715 Anvil Way  
Surrey, BC V3W 6A2  
Tel. (604) 590-5100  
800-818-2666  
Fax. (604) 590-5105